

A Cabinet with a Unique Door

DIY Furniture Plans to Build a Diamond Single Door Cabinet

When I saw the piece that inspired this cabinet, I was in love! The original cabinet is longer with four doors. The DIY furniture plans to build a Diamond Single Door Cabinet feature a door with triangular pieces attached to the door frame to create the center diamond with a piece of Plexiglas attached to the back. The cabinet also has a shelf inside and can serve many uses in the home!

**build a
diamond
single door
cabinet**

DESIGNS BY STUDIO C

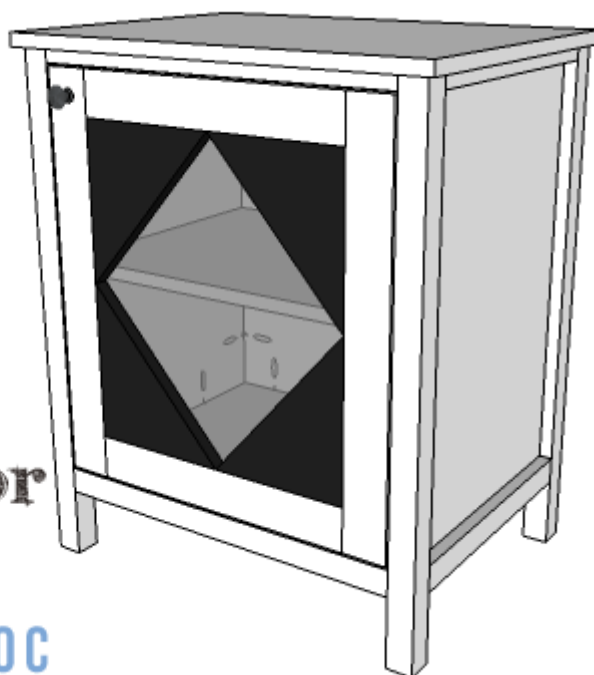

Materials:

- 1-1/4" pocket hole screws
- 2-1/2" pocket hole screws
- 1-3/4" brad nails
- 3/4" screws
- Edge banding

- 1/4" Plexiglas
- 1 Set of hinges
- 1 Cabinet pull
- Wood glue
- Sandpaper (100, 150, 220 grits)
- Finishing supplies (primer & paint, or stain, sealer)

Tools needed:

- Miter saw or Circular saw
- Table saw
- Iron for edge banding
- Drill
- Pocket hole jig
- Pneumatic brad nailer with compressor
- Sander

Lumber:

- 1 – 1x2 at 8'
- 1 – 1x3 at 8'
- 1 – 1x10 at 4'
- 2 – 2x2 at 6'
- 1 – 2x2 at 8'
- 1 – 4' x 8' sheet of 3/4" plywood

Cut List:

- 4 – 2x2 at 29-1/4" – Legs
- 2 – 2x2 at 15" – Lower Side Framing
- 2 – 1x2 at 15" – Upper Side Framing
- 2 – 3/4" plywood at 15" x 23" – Side Panels
- 2 – 2x2 at 21" – Lower Stretchers
- 1 – 3/4" plywood at 15" x 21" – Bottom
- 2 – 1x2 at 21" – Upper Stretchers
- 1 – 3/4" plywood at 21" x 23" – Back
- 1 – 3/4" plywood at 15-3/8" x 21" – Shelf

- 1 – 3/4" plywood at 18-1/2" x 25" – Top
- 2 – 1x3 at 15-3/4" – Door Rails
- 2 – 1x3 at 22-3/4" – Door Stiles
- 4 – 1x10 pieces cut at 7-7/8" x 8-7/8" – Triangle Detail
- 1 – 1/4" Plexiglas at 17-3/4" x 19-3/4" – Door Panel



Click on the drawings for a larger view!

Step One

Cut the pieces for the legs, side framing and side panels. Set the pocket hole jig for 1-1/2" material and drill pocket holes in each end of the 2x2 framing pieces. Secure the 2x2 pieces to the legs using glue and 2-1/2" pocket hole screws.

Set the pocket hole jig for 3/4" material and drill pocket holes in each end of the 1x2 framing pieces as well as all four edges of the side panels. Secure the framing pieces to the upper portion of the legs using glue and 1-1/4" pocket hole screws. Secure the panel to the framing and legs using glue and 1-1/4" pocket hole screws. The back face of the panels will be flush with the inside faces of the legs.

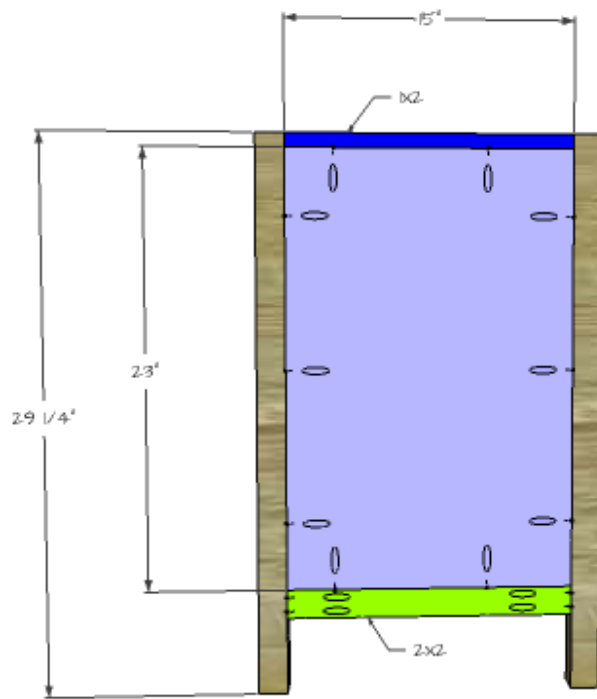

DESIGNS BY
STUDIO C

Step Two

Cut the pieces for the 2x2 lower stretchers. Set the pocket hole jig for 1-1/2" material and drill pocket holes in each end. Secure the lower stretchers to the legs using glue and 2-1/2" pocket hole screws.

Set the pocket hole jig for 3/4" material and drill pocket holes in as all four edges of the bottom. Secure the bottom to the lower front stretchers and the side framing using glue and 1-1/4" pocket hole screws. The top face of the bottom will be flush with the top face of the lower stretchers.

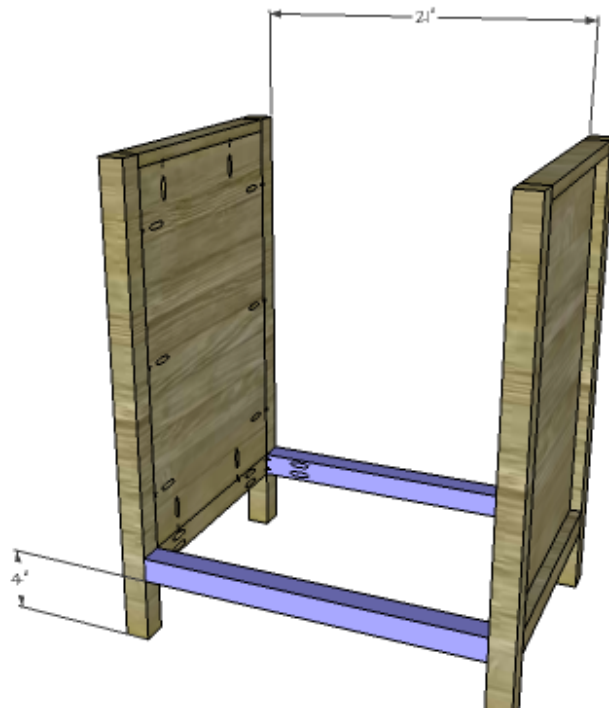

DESIGNS BY
STUDIO C

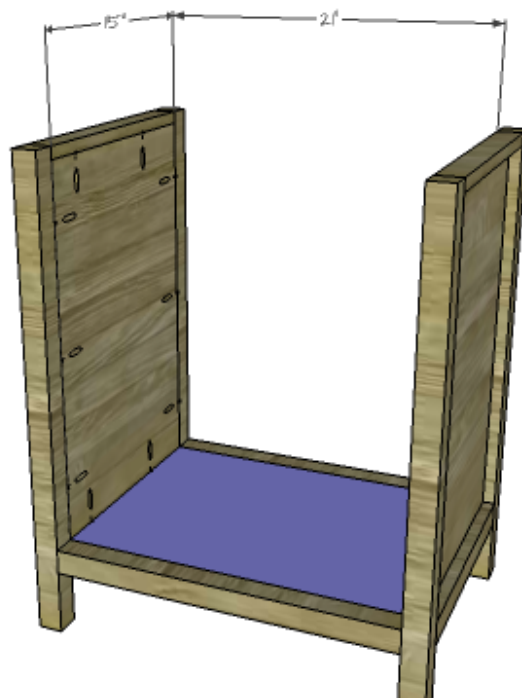

DESIGNS BY
STUDIO C

Step Three

Cut the pieces for the upper stretchers and drill pocket holes in each end. Secure the upper stretchers to the upper portion of the legs using glue and 1-1/4" pocket hole screws.

Cut the piece for the back and drill pocket holes in all four edges. Secure the back to the legs and stretchers using glue

and 1-1/4" pocket hole screws. The back face of the panel will be flush with the inside faces of the legs.

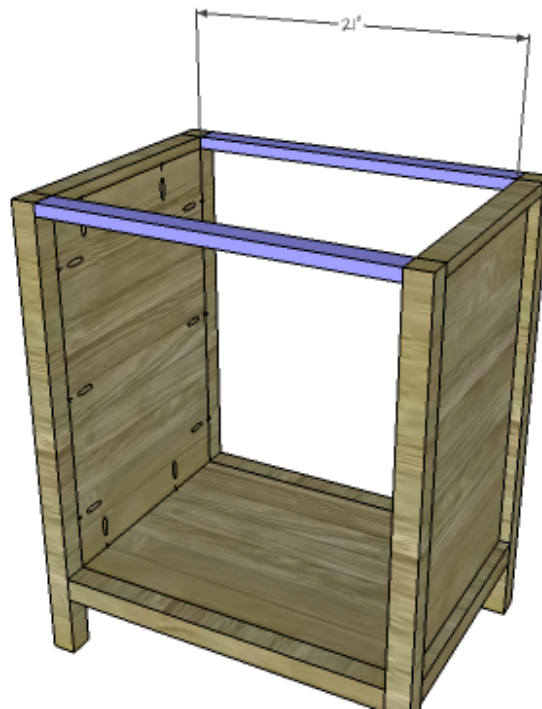

DESIGNS BY
STUDIO C

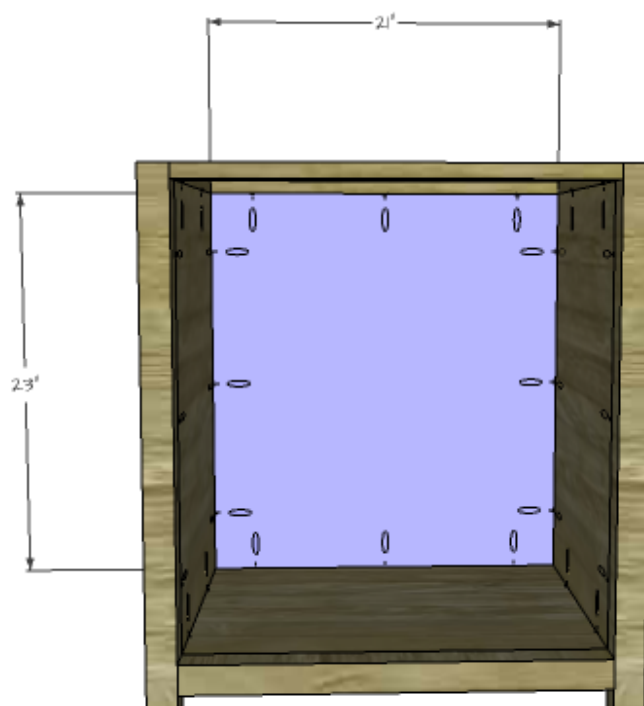

DESIGNS BY
STUDIO C

Step Four

Cut the piece for the shelf and drill pocket holes in the side and back edges. Secure the shelf to the sides and back using glue and 1-1/4" pocket hole screws. the shelf will be

positioned 1-1/8" back from the front face of the legs which makes it flush with the back.

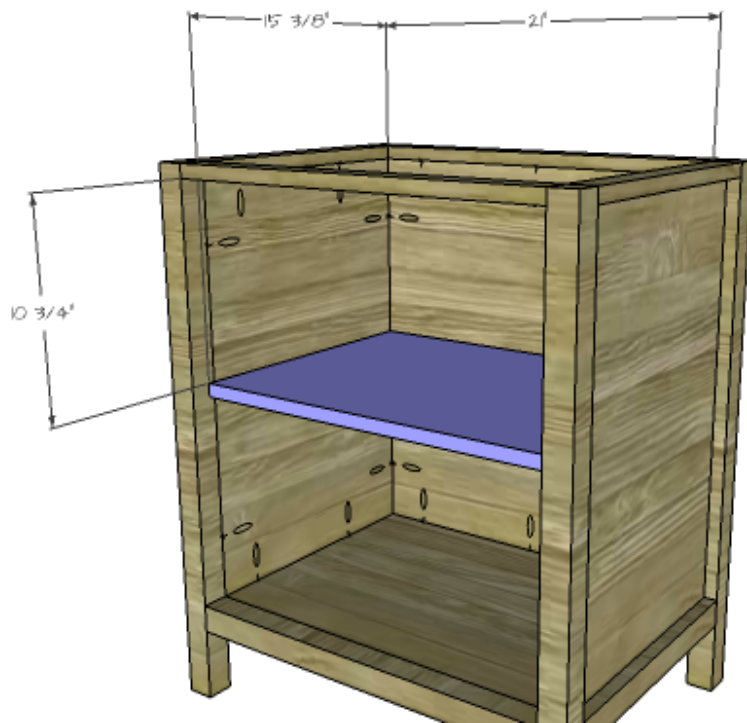

DESIGNS BY
STUDIO C

Step Five

Cut the piece for the top. The top will overhang the sides and front by 1/2". Secure the top in place using glue and 1-3/4" brad nails.

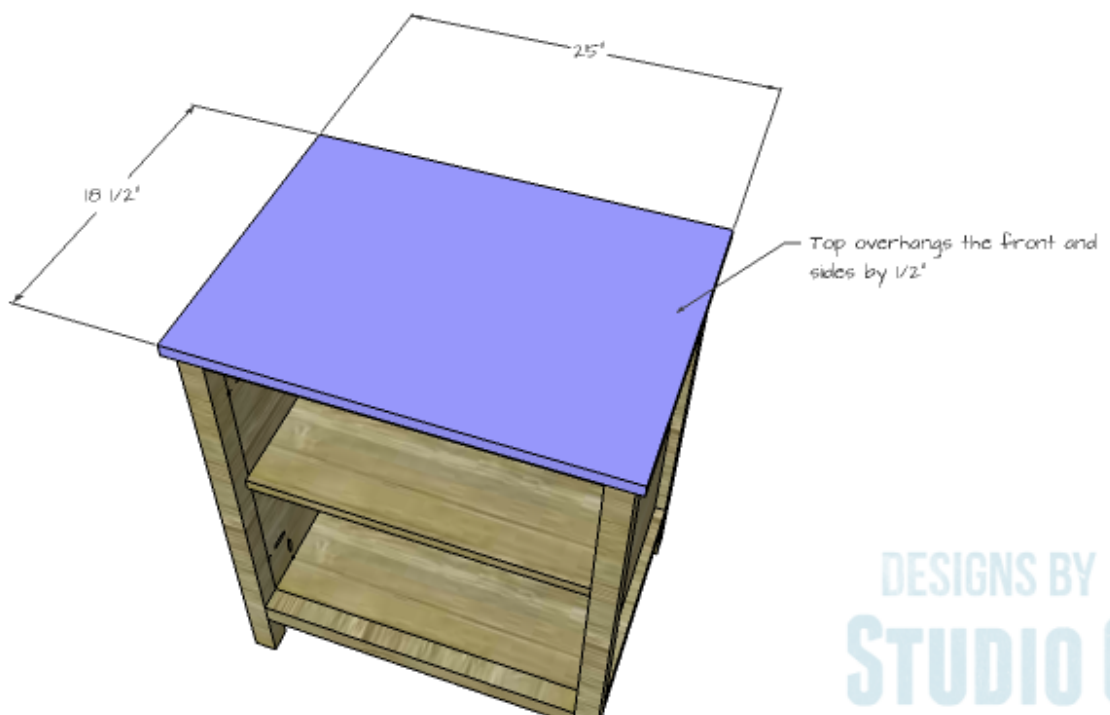

DESIGNS BY
STUDIO C

Step Six

Cut the pieces for the door frame. Drill pocket holes in each end of the shorter frame pieces (the door rails). Assemble the frame using glue and 1-1/4" pocket hole screws.

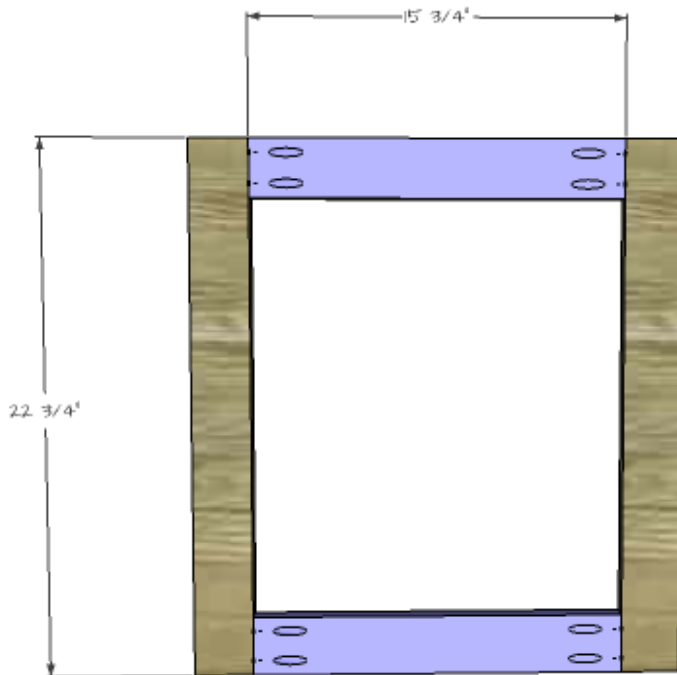

DESIGNS BY
STUDIO C

Step Seven

Cut the triangular pieces for the door frame and drill pocket holes in the pieces as shown. Secure the pieces to the inner edge of the frame using glue and 1-1/4" pocket hole screws.

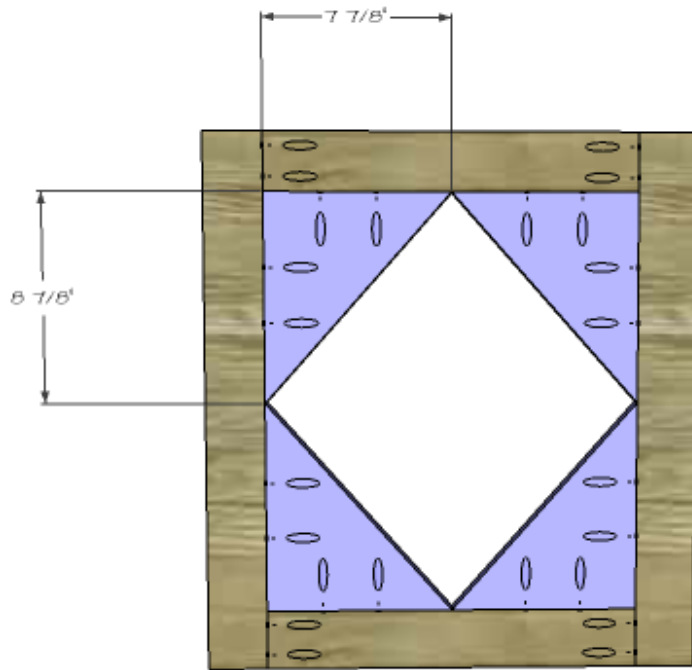

DESIGNS BY
STUDIO C

Step Eight

Cut the piece of Plexiglas for the back of the door. Drill holes in the corners and longer edges of the Plexiglas and attach it to the inside of the door using $\frac{3}{4}$ " screws.

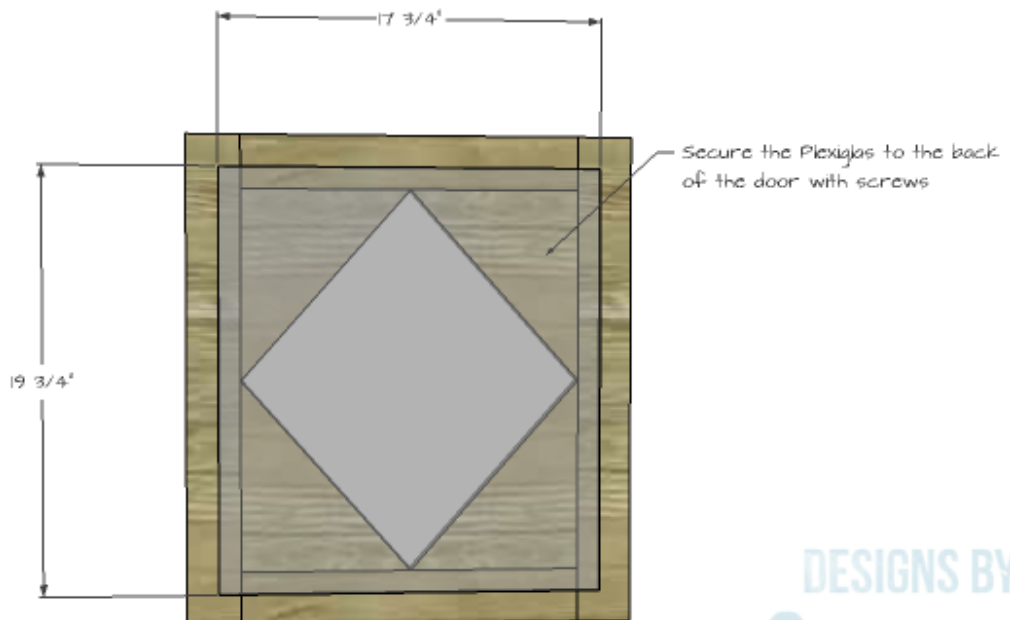

DESIGNS BY
STUDIO C

Install the hinges on the door, then install the door in the cabinet. There will be a $\frac{1}{8}$ " gap around all sides of the door

in the opening.

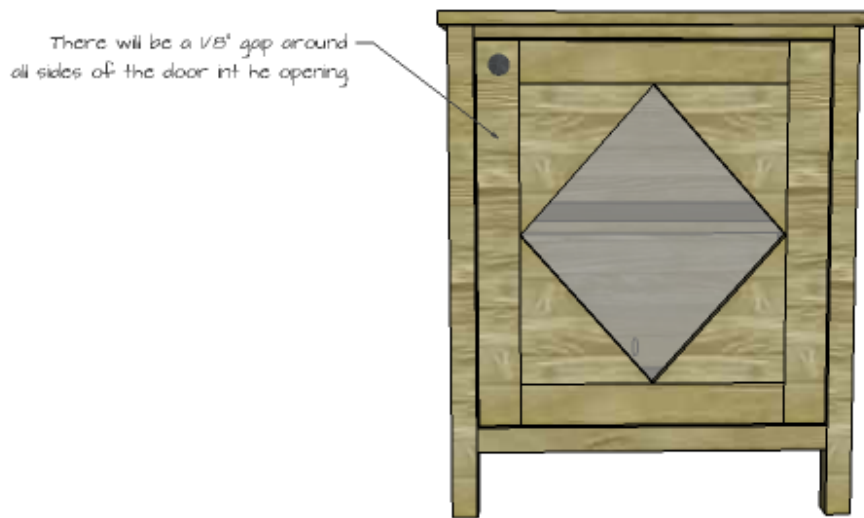

DESIGNS BY
STUDIO C

Install the cabinet knob.

Finish as desired.

This cabinet would be fabulous if used as a bar or as a media stand! Have any questions about the DIY furniture plans to build a Diamond Single Door Cabinet? Leave a comment below!